

ECE

3 Input Shaft

4 Input Shaft

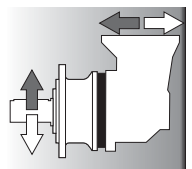

EXB

Input Version

ECR

IEC

ECE 1 2 3 4 5 B

ECE 1 2 5 A

ECR 0 1 2 3 4 B

ECR 0 1 2 3 A

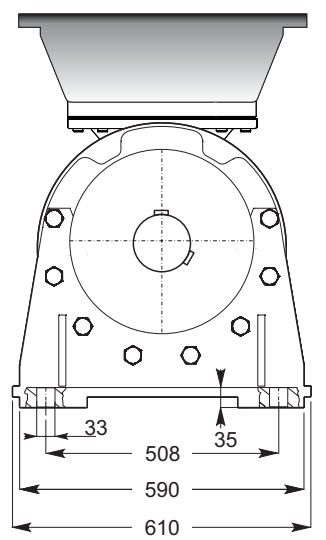
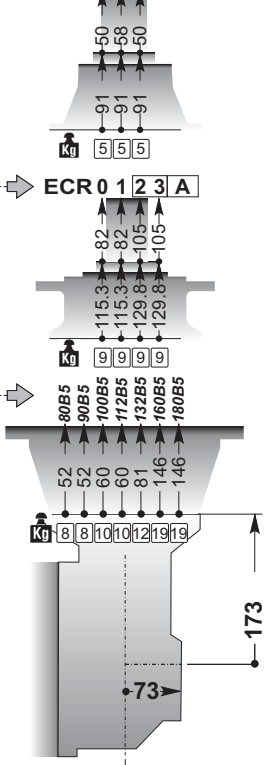
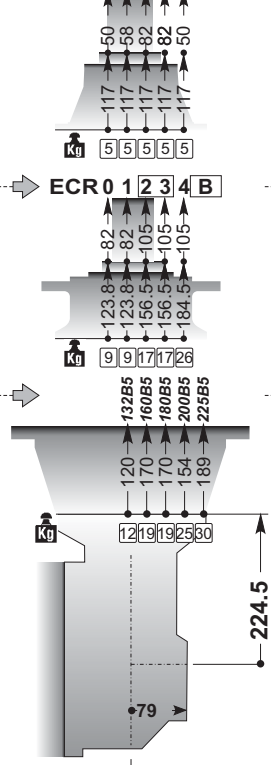
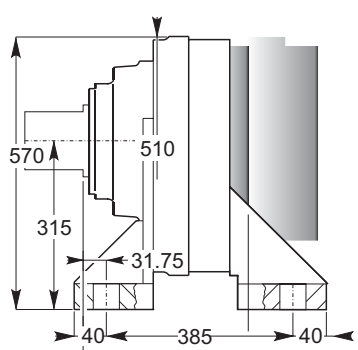

4
3

600 → 6003 495 → 677.5 → 6004 465

FD

46.2 Kg

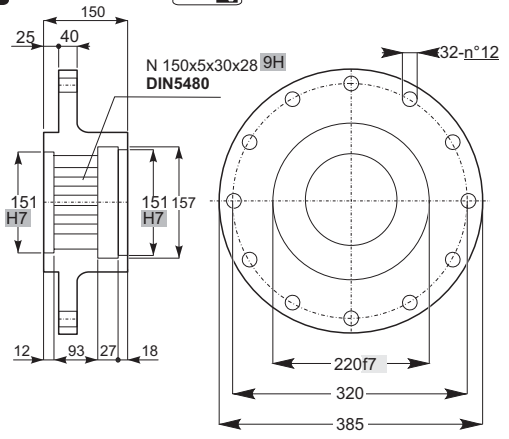

ID

N 150x5x30x28 9H DIN5480

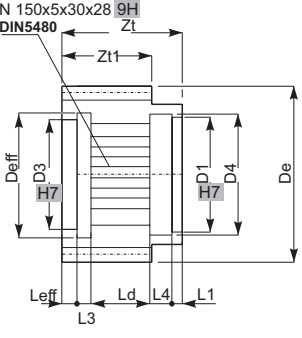

ID	m	Z	X	De

FF

3.2 Kg

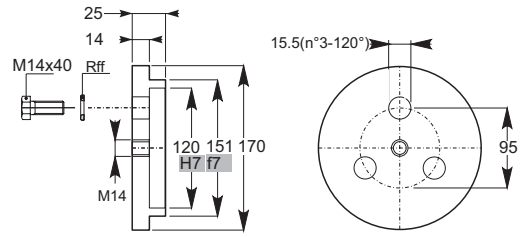

BD

24.5 Kg

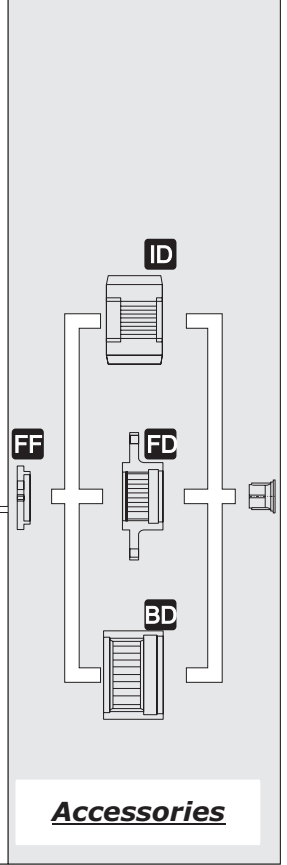
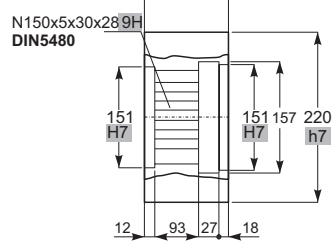

Accessories

mm
C

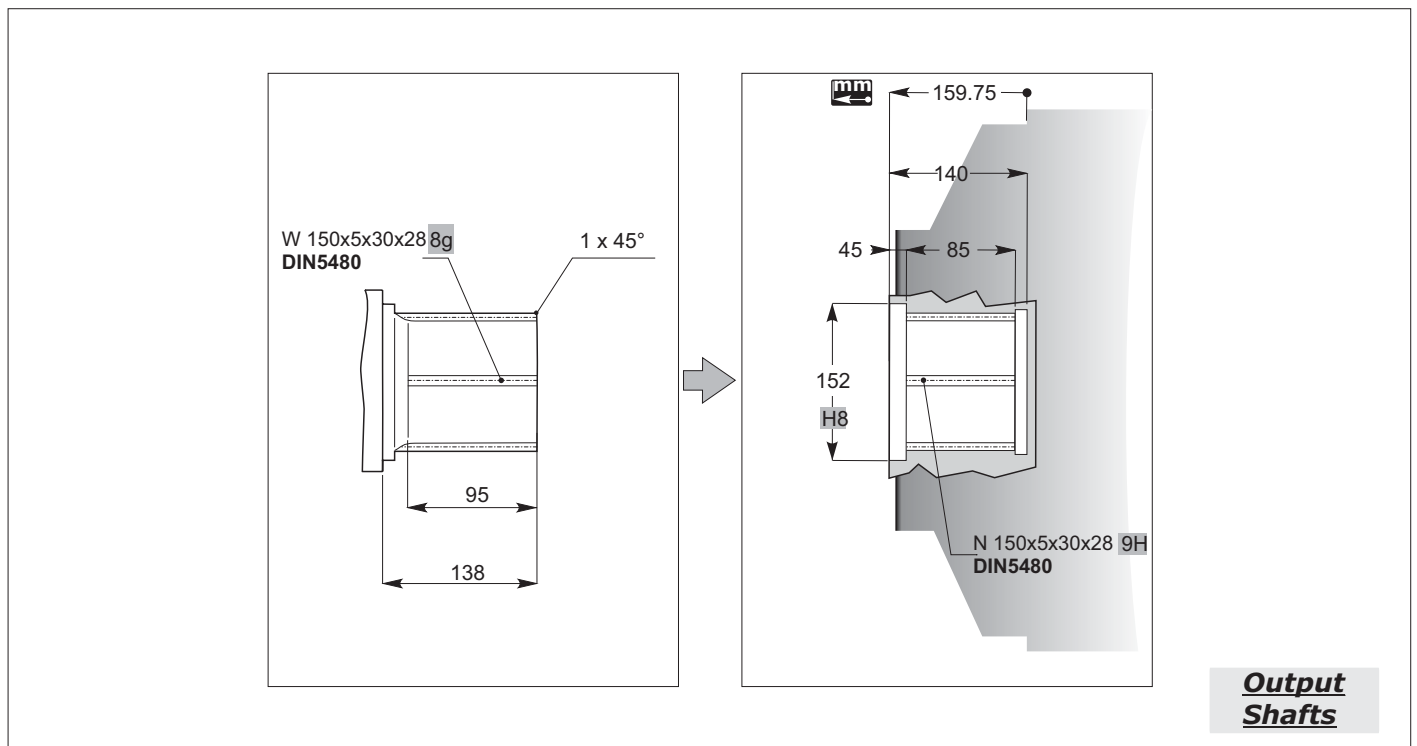
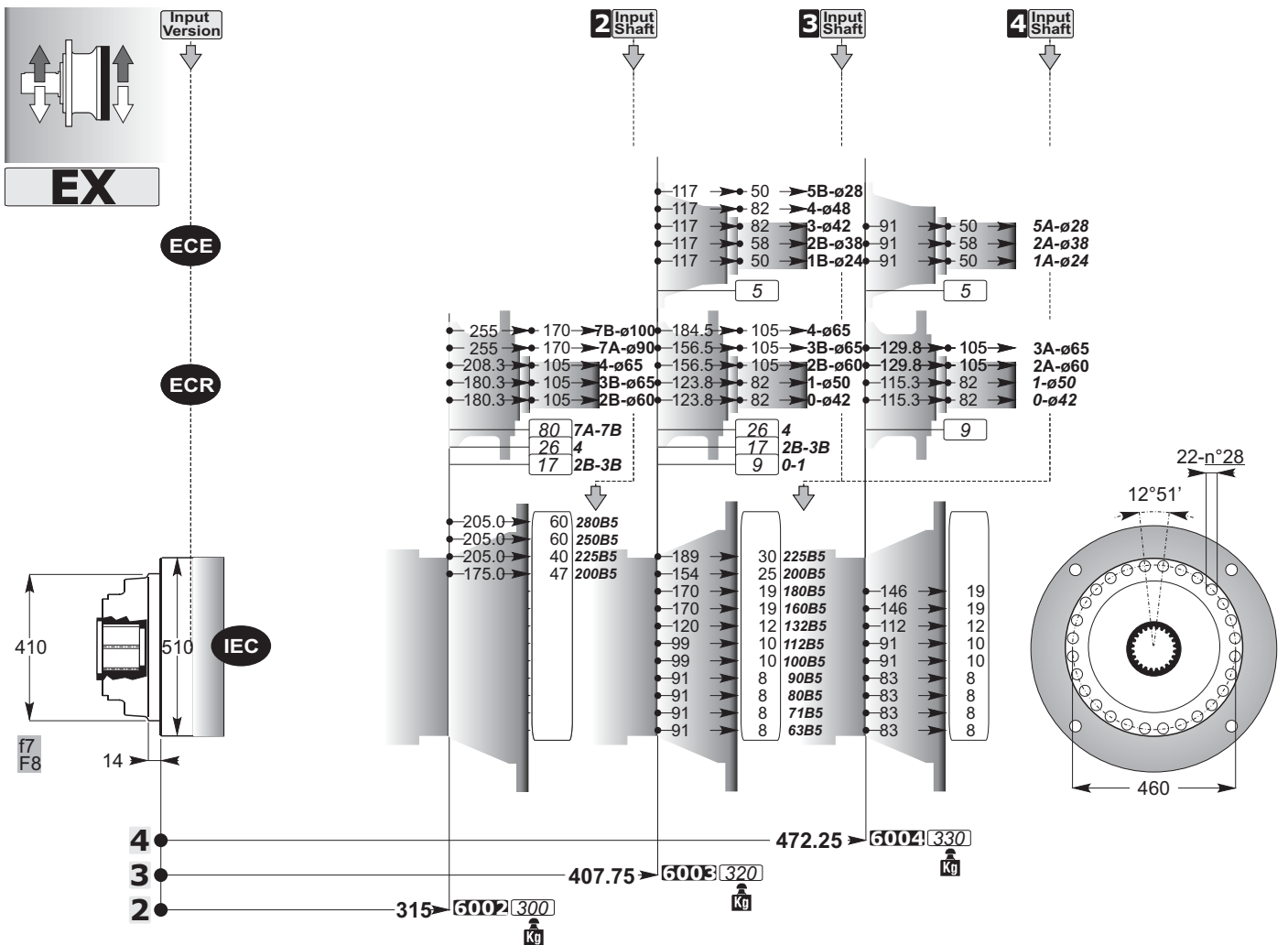

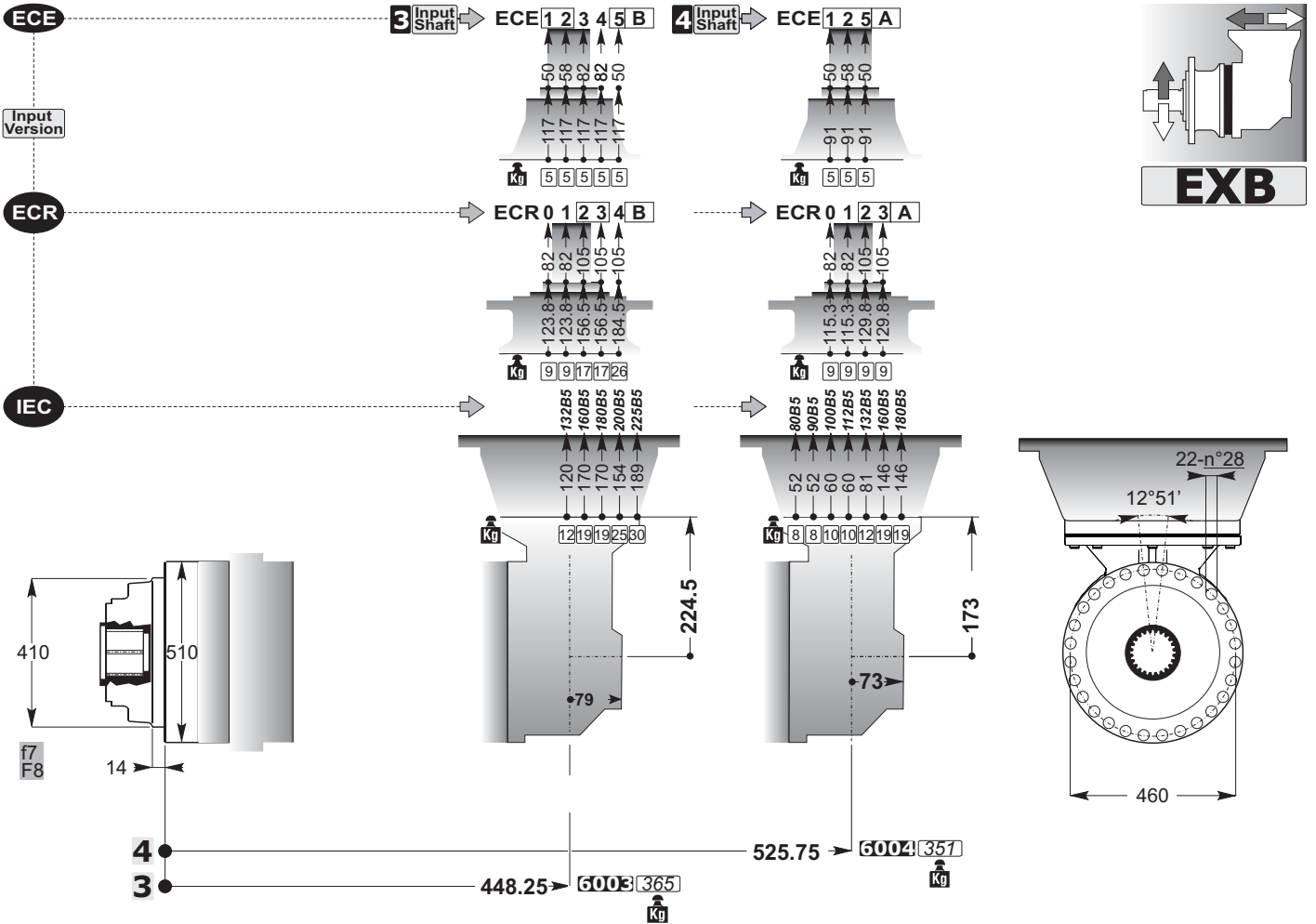

SD

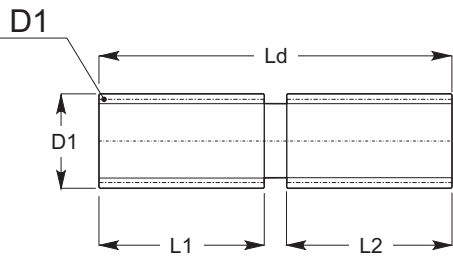

Accessories

mm
C

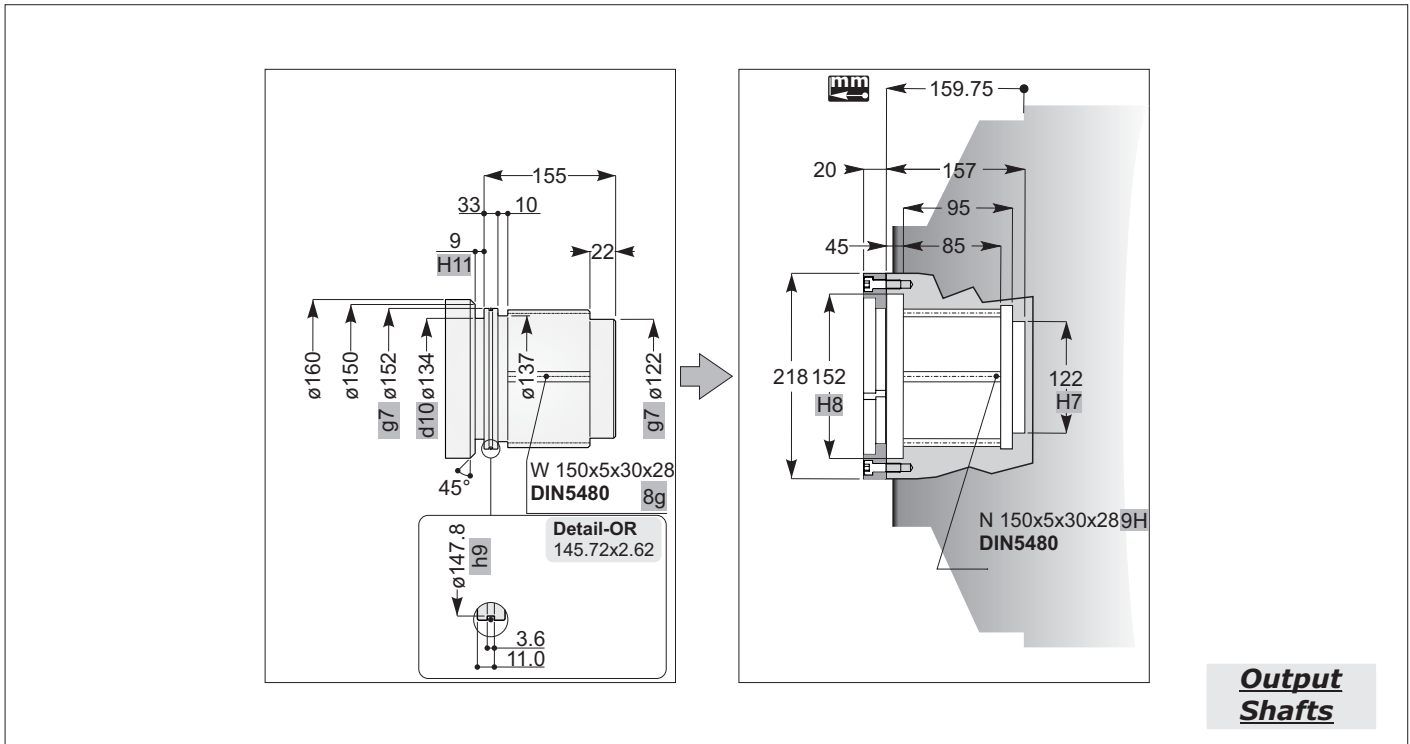
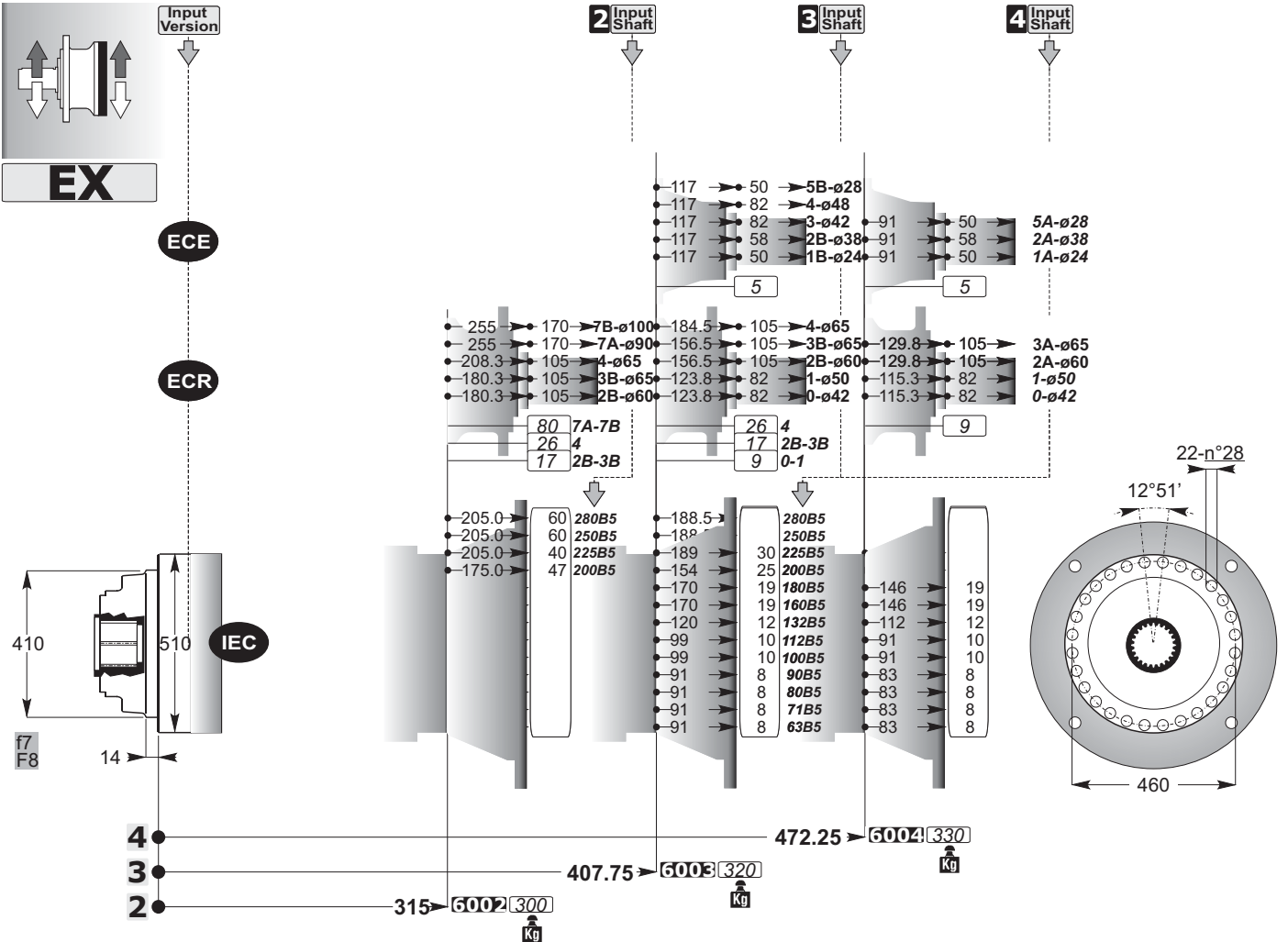

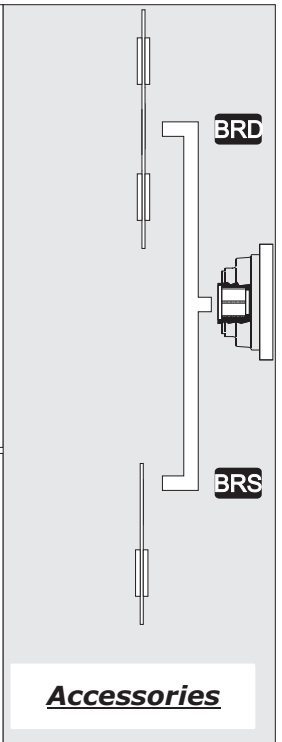
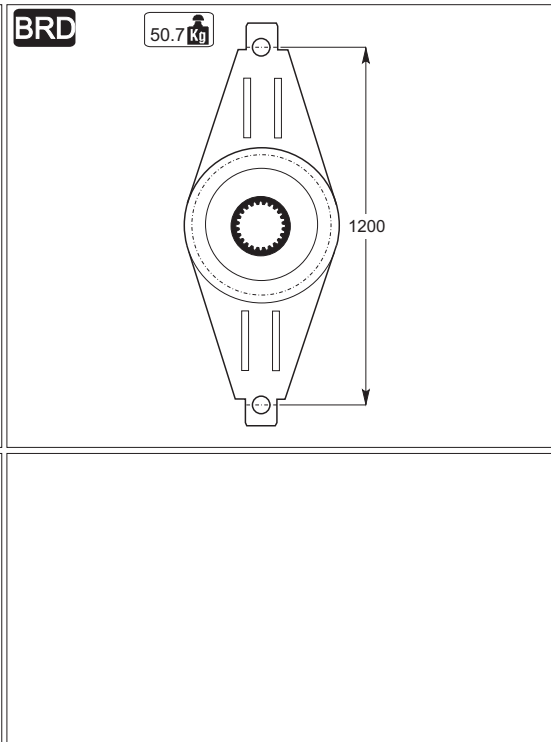
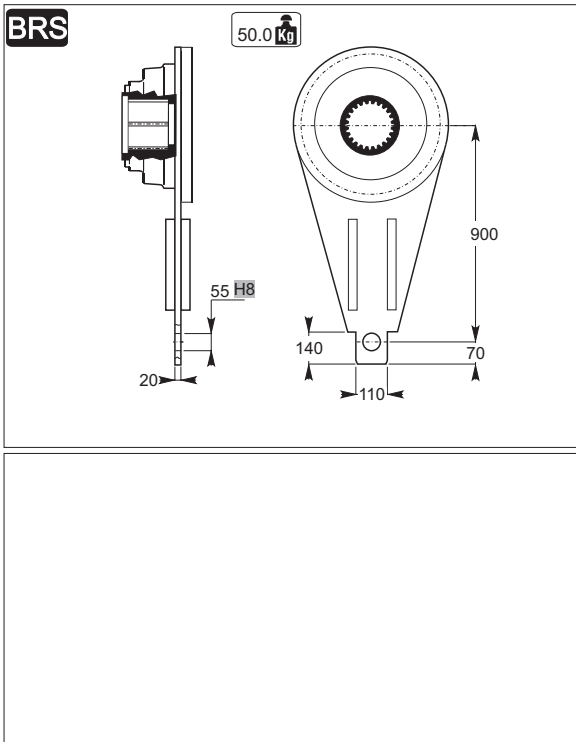
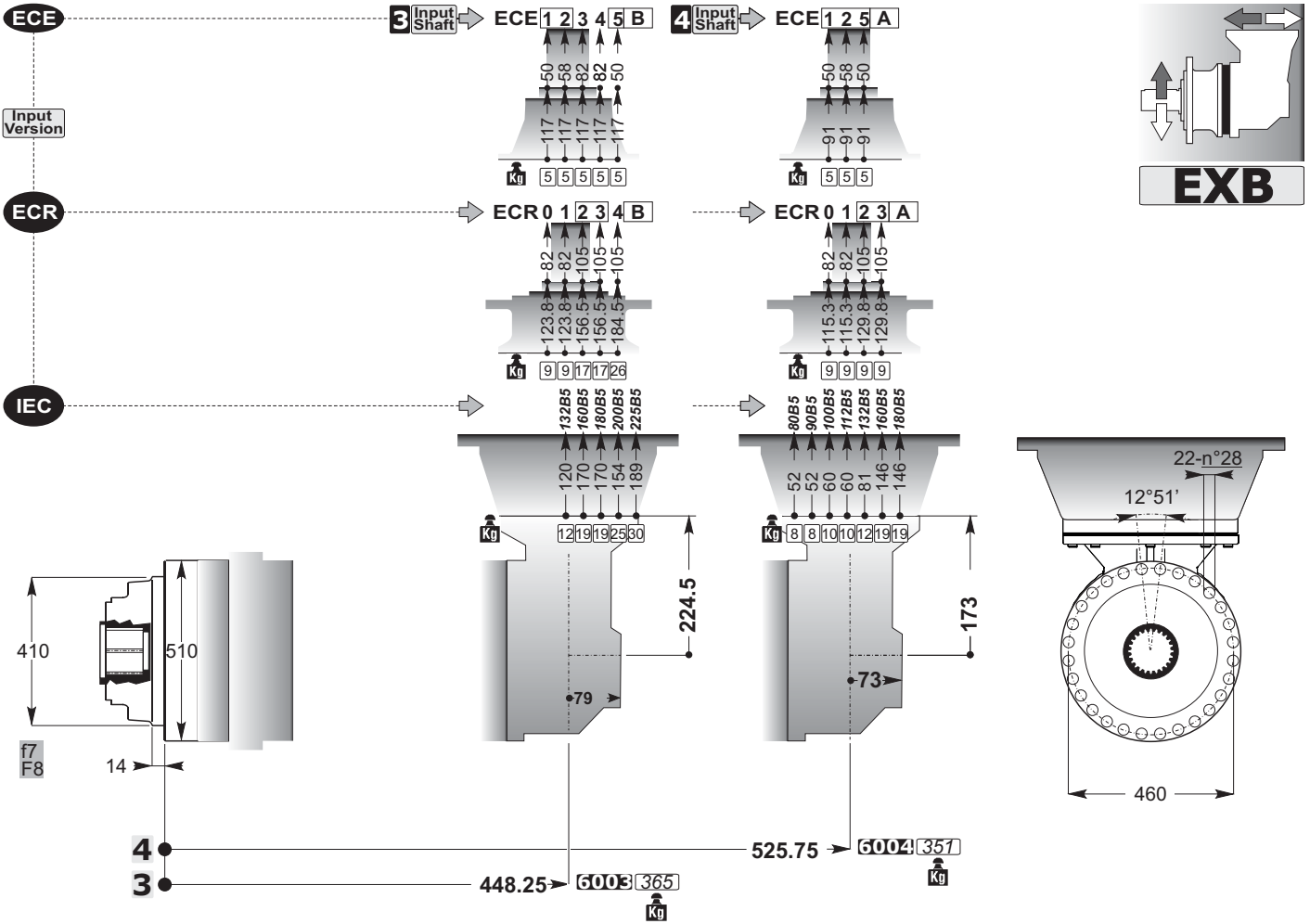

mm
C

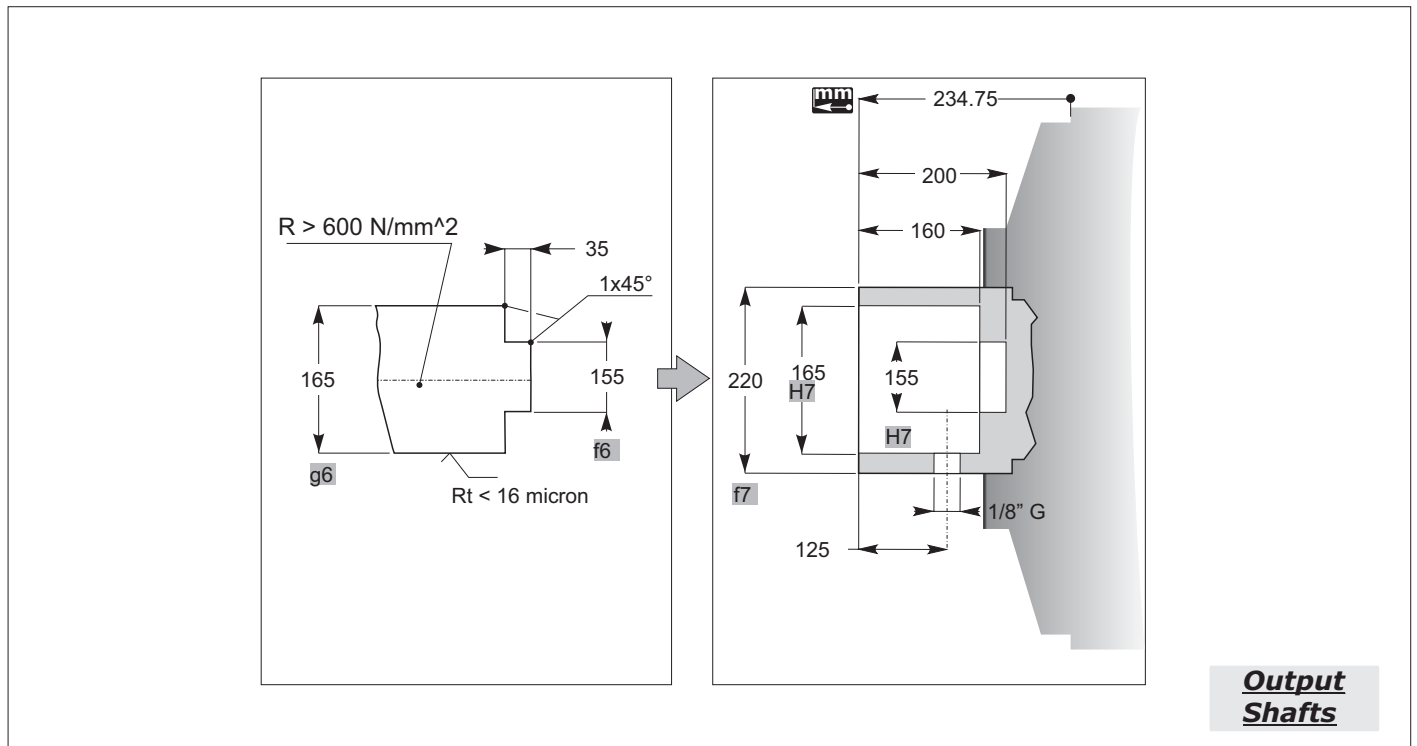
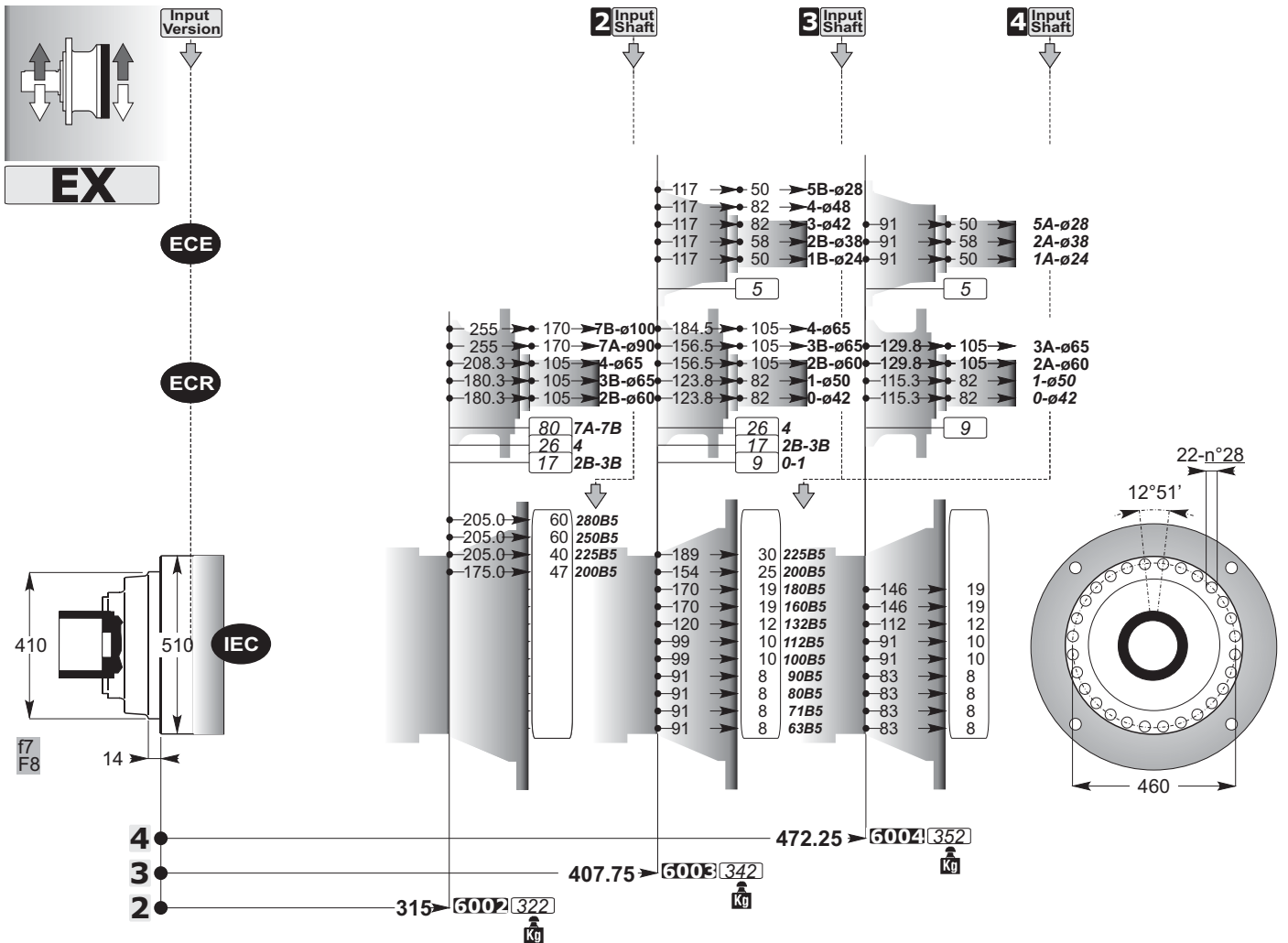

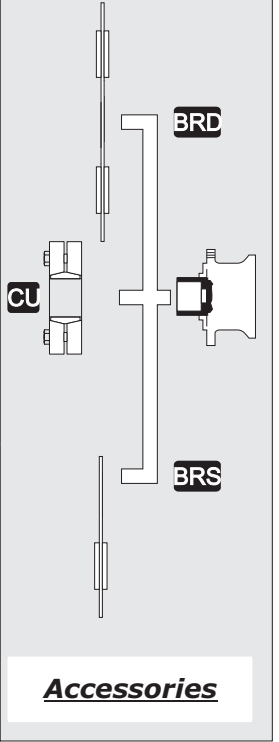
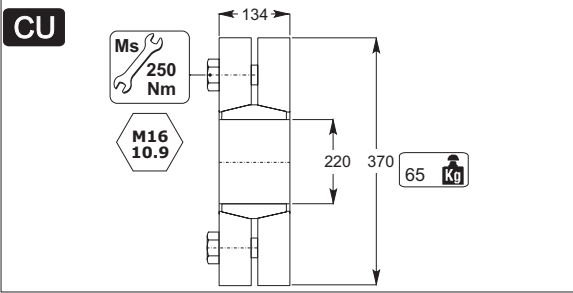
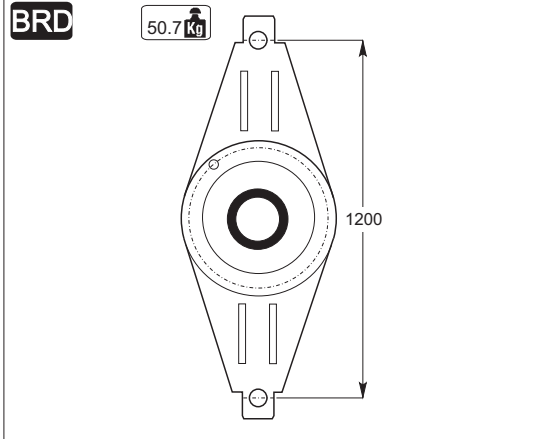
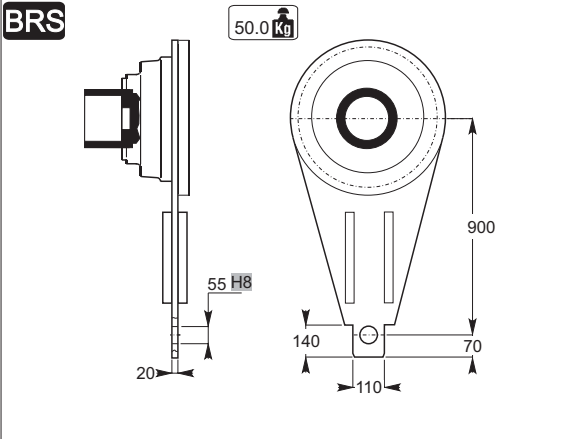
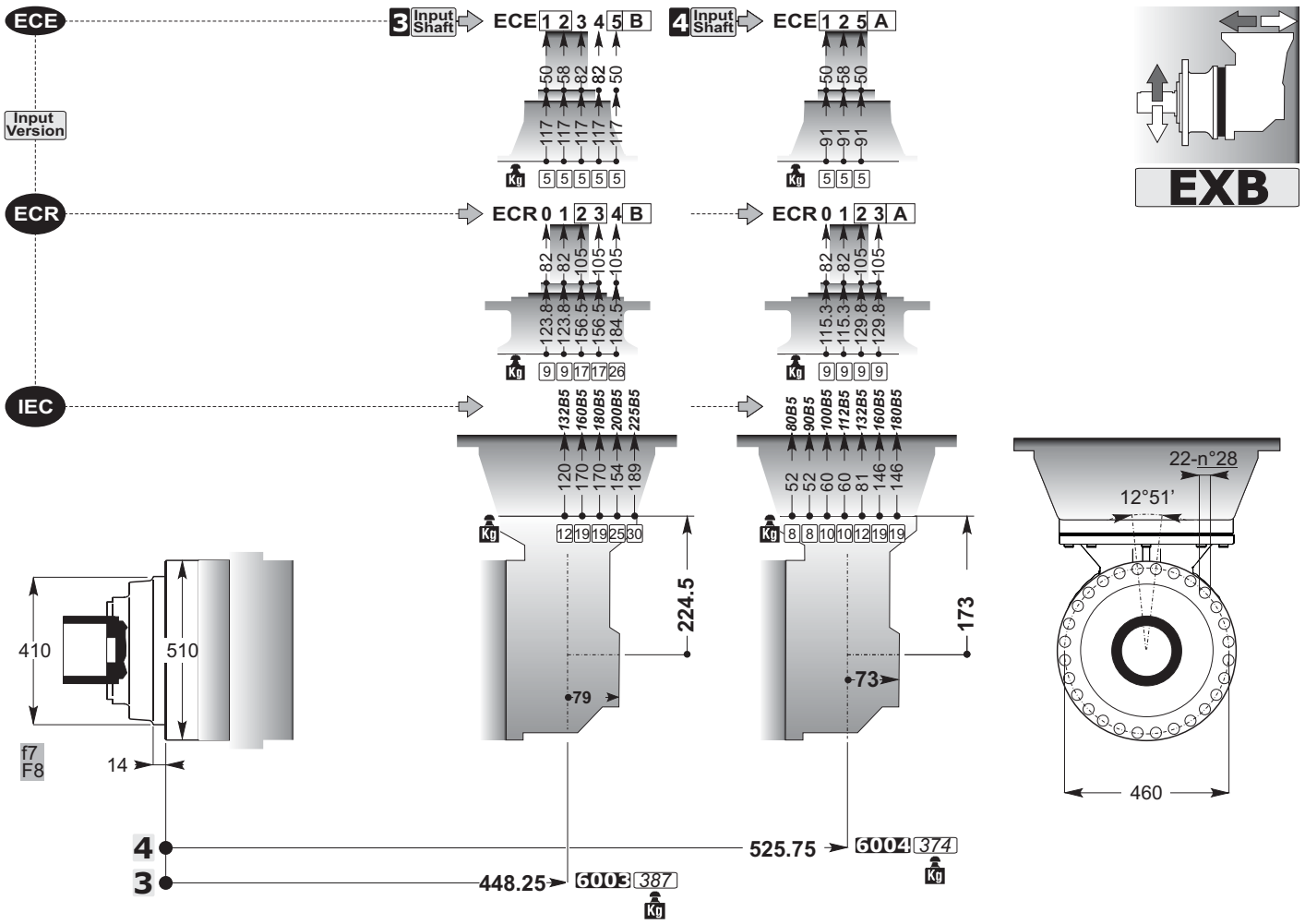

mm
C